

# The ARBOR Townhome

**SQUARE FEET:** 2,616  
**FLOOR LEVELS:** 1<sup>ST</sup> AND 2<sup>ND</sup>

6 PRIVATE BEDROOMS  
6 PRIVATE BATHROOMS

**Floor Displayed:** 1<sup>ST</sup>

**Common Area Details:**

Kitchen with granite countertops, sleek black appliances, in-unit washer and dryer, common Area with one couch, two chairs, one end table, one coffee table, four barstools, an entertainment center, and a 42" television with Standard Definition DirecTV.

**Bedroom A w/ Private Bathroom:**

Full-size bed, four-drawer dresser, desk, desk chair, desk hutch, mirrored closet doors, closet with built-in organizers, mini-fridge and microwave, and shower/tub combination in bathroom.

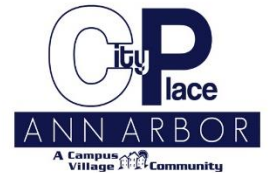
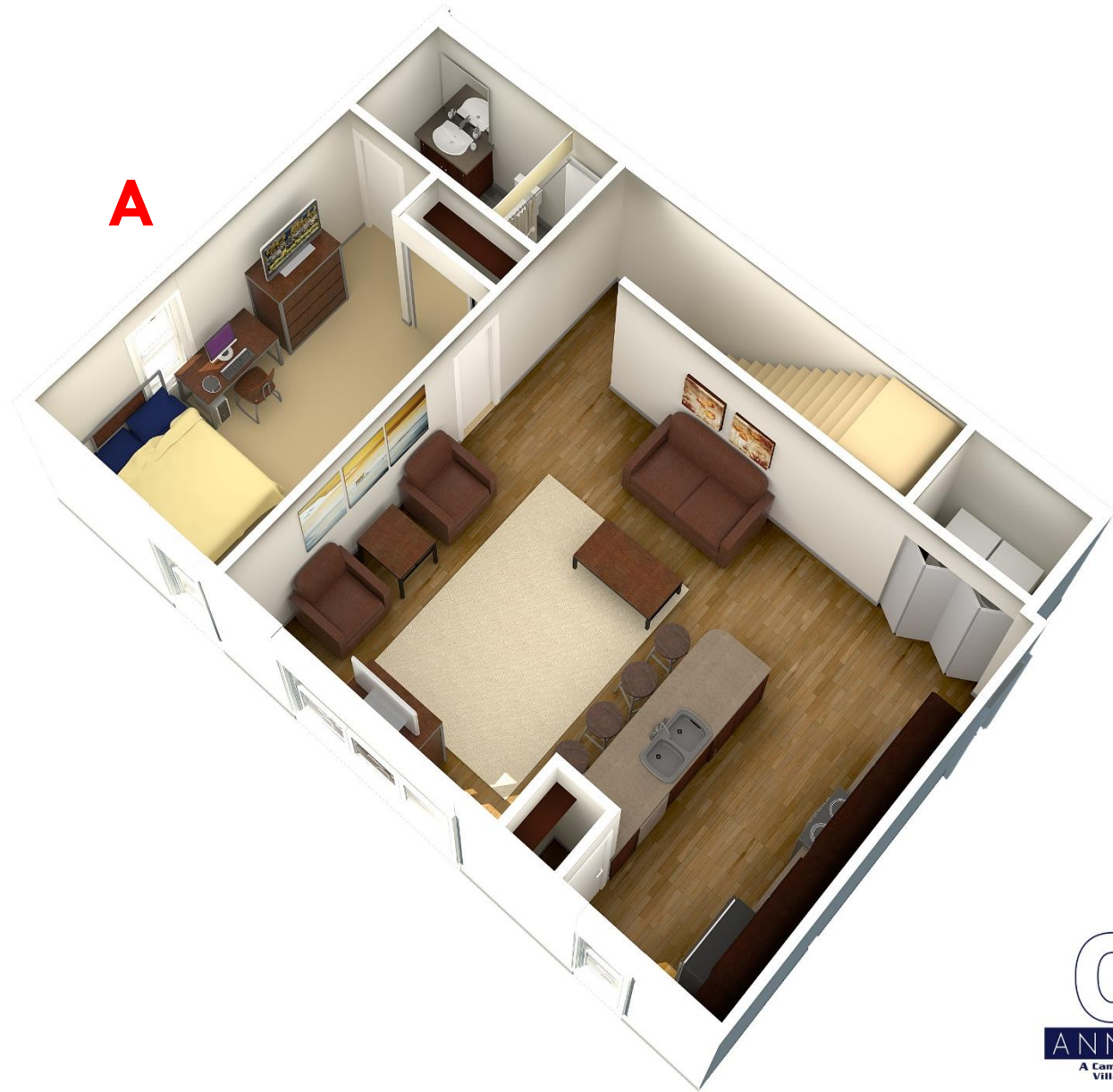

\*NOTICE: Photos may not represent actual product and may not guarantee floor plan styles, colors, contents or decor as demonstrated; contact the leasing office for specific details.

# The ARBOR Townhome

**SQUARE FEET:** 2,616  
**FLOOR LEVELS:** 1<sup>ST</sup> AND 2<sup>ND</sup>

6 PRIVATE BEDROOMS  
6 PRIVATE BATHROOMS

**Floor Displayed:** 2<sup>nd</sup>

**Common Area Details:**

Media Room with two couches, two chairs, one end table, one coffee table, wall-mounted entertainment center, Blu-Ray player with surround sound, 50" television with HD and an extended DirecTV channel line-up.

**Bedrooms B-F w/ Private**

**Bathrooms:** All bedrooms include a full-size bed, four-drawer dresser, desk, desk chair, desk hutch, mirrored closet doors, closet with built-in organizers, mini-fridge and microwave, and shower/tub combination in bathroom.

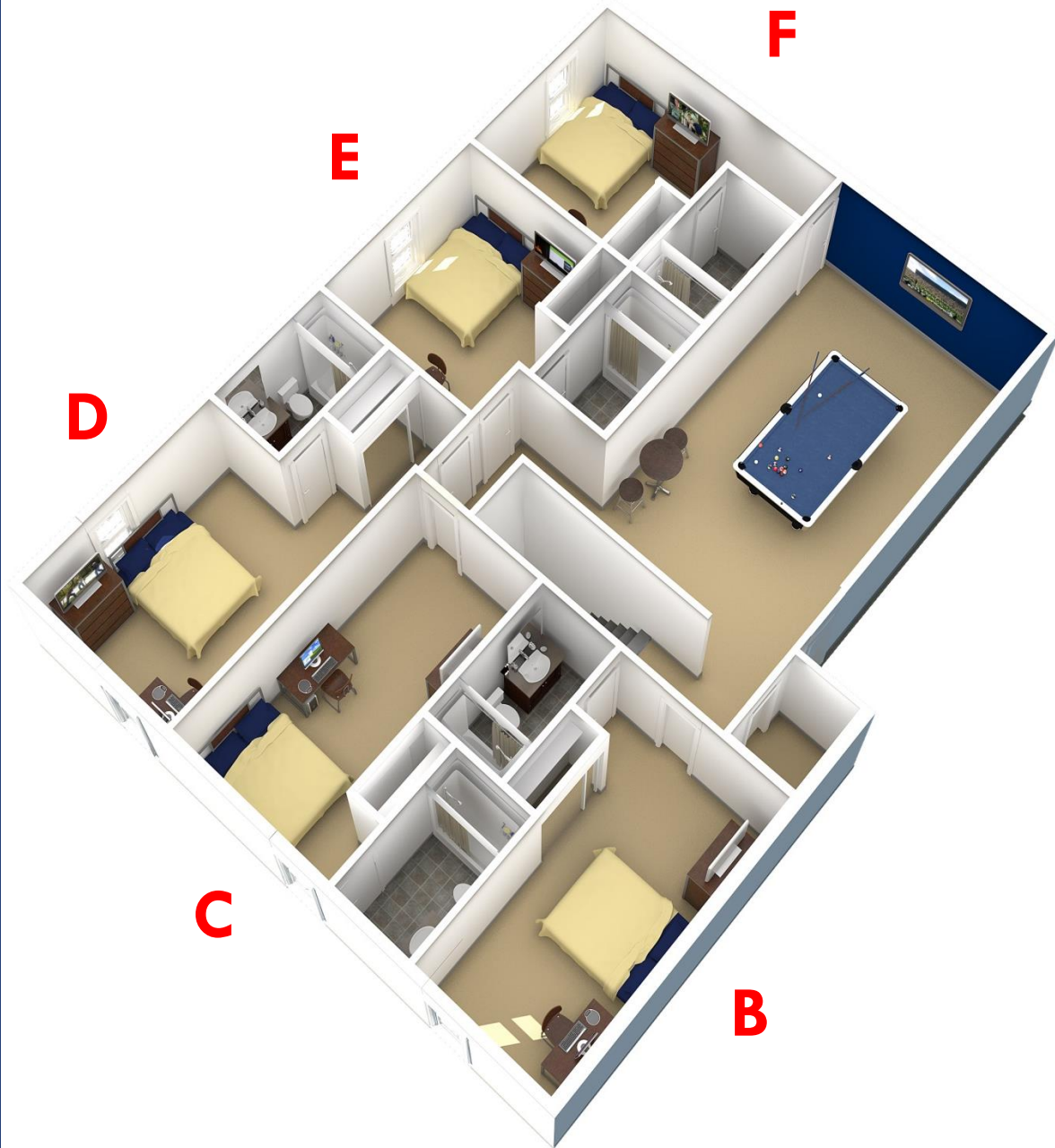

\*NOTICE: Photos may not represent actual product and may not guarantee floor plan styles, colors, contents or decor as demonstrated; contact the leasing office for specific details.

